

CONUZIONI

RACCORDI

Serie 3000

Serie 6000

Raccordi filettati - Threaded fittings

Raccorderia forgiata serie 2-3-6000 IN-A 105 AISI 304-316

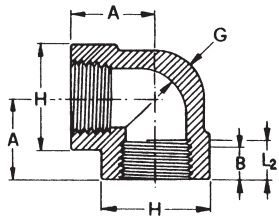

gomiti a 90°

To ANSI B 16.11 – BS 3799

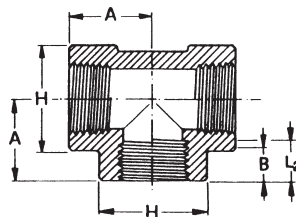

pezzi a tee

To ANSI B 16.11 – BS 3799

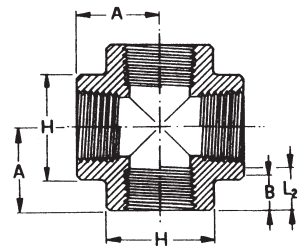

croci

To ANSI B 16.11 – BS 3799

RATING serie	inch	NOMINAL PIPE SIZE						Ø NOMINALE					
		1/8	1/4	3/8	1/2	3/4	1	1 1/4	1 1/2	2	2 1/2	3	4
2000 lb	A	20.6	20.6	24.6	28.5	33.3	38.1	44.5	50.8	60.5	76.2	85.9	106.4
	H	22.4	22.4	25.4	33.3	38.1	46.0	55.6	62.0	75.4	92.0	109.5	146.0
	G	3.2	3.2	3.2	3.2	3.2	3.7	3.9	4.0	4.3	5.6	6.0	6.6
3000 lb	A	20.6	24.6	28.5	33.3	38.1	44.5	50.8	60.5	63.5	82.6	95.3	114.3
	H	22.4	25.4	33.3	38.1	46.0	55.6	62.0	75.4	84.1	101.6	120.6	152.4
	G	3.2	3.3	3.5	4.1	4.3	5.0	5.3	5.6	7.1	7.6	8.8	11.2
6000 lb	A	20.6	28.5	33.3	38.1	44.5	50.8	60.5	76.2	82.6	95.3	106.4	114.3
	H	25.4	33.3	38.1	46.0	55.6	62.0	75.4	84.1	101.6	120.6	146.0	152.4
	G	6.4	6.6	7.0	8.2	8.5	9.9	10.6	11.1	12.1	15.3	16.6	18.7
THREAD filetto NPT	B	6.4	8.1	9.1	10.9	12.7	14.7	17.0	17.8	19.0	23.6	25.9	27.7
	L ₂	6.7	10.2	10.4	13.6	13.9	17.3	17.9	18.4	19.2	28.9	30.5	33.0

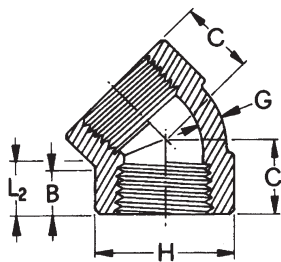

gomiti a 45°

To ANSI B 16.11 – BS 3799

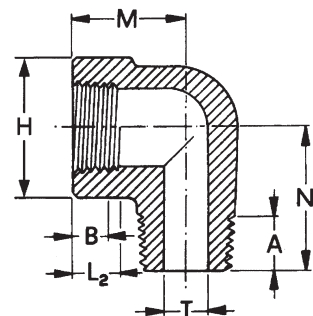

gomiti M/F

STANDARD DIMENSIONS

RATING serie	inch	NOMINAL PIPE SIZE						Ø NOMINALE					
		1/8	1/4	3/8	1/2	3/4	1	1 1/4	1 1/2	2	2 1/2	3	4
2000 lb	C	17.5	17.5	19.0	22.4	25.4	28.5	33.3	35.0	42.9	52.3	63.5	79.2
	H	22.4	22.4	25.4	33.3	38.1	46.0	55.6	62.0	75.4	92.0	109.5	146.0
	G	3.2	3.2	3.2	3.2	3.2	3.7	3.9	4.0	4.3	5.6	6.0	6.6
3000 lb	C	17.5	19.0	22.4	25.4	28.5	33.3	35.0	42.9	43.7	52.3	63.5	79.2
	H	22.4	25.4	33.3	38.1	46.0	55.6	62.0	75.4	84.1	101.6	120.6	152.4
	G	3.2	3.3	3.5	4.0	4.3	5.0	5.3	5.6	7.1	7.6	8.8	11.2
	M	-	24.6	28.5	33.3	38.1	44.5	50.8	60.5	63.5	-	-	-
	N	-	26.7	32.0	35.3	40.9	50.0	61.0	69.8	82.5	-	-	-
6000 lb	T	-	7.5	10.5	13.5	18.5	23.5	32.0	37.5	48.5	-	-	-
	C	19.0	22.4	25.4	28.5	33.3	35.0	42.9	47.3	52.3	63.5	79.2	79.2
	H	25.4	33.3	38.1	46.0	55.6	62.0	75.4	84.1	101.6	120.6	146.0	152.4
	G	6.4	6.6	7.0	8.2	8.5	9.9	10.6	11.1	12.1	15.3	16.6	18.7
	M	-	28.5	33.3	38.1	44.5	50.8	60.5	63.5	-	-	-	-
	N	-	32.0	35.3	40.9	50.0	61.0	69.8	82.5	-	-	-	-
THREAD filetto NPT	T	-	5.5	7.5	10.5	12.5	16.5	24.0	29.5	-	-	-	-
	A	9.6	11.2	12.7	14.2	15.7	19.0	20.6	20.6	22.3	26.9	28.4	31.7
	B	6.4	8.1	9.1	10.9	12.7	14.7	17.0	17.8	19.0	23.6	25.9	27.7
	L ₂	6.7	10.2	10.4	13.6	13.9	17.3	17.9	19.4	19.2	28.9	30.5	33.0

Raccordi filettati - Threaded fittings

Raccorderia forgiata serie 2-3-6000 IN-A 105 AISI 304-316

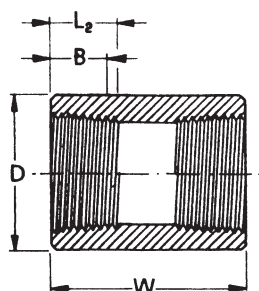

manicotti

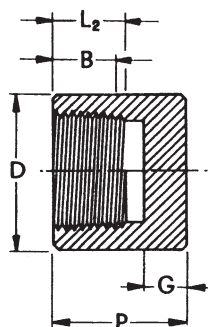

tappi femmina

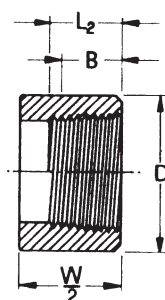

mezzi manicotti

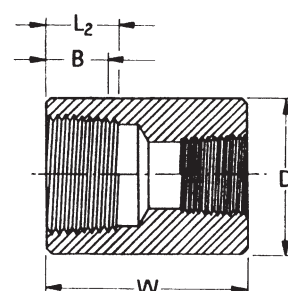

manicotti ridotti

To ANSI B 16.11 – BS 3799

To ANSI B 16.11 – BS 3799

To ANSI B 16.11 – BS 3799

To ANSI B 16.11 – BS 3799

RATING serie	inch	NOMINAL PIPE SIZE					Ø NOMINALE						
		1/8	1/4	3/8	1/2	3/4	1	1 ¼	1 ½	2	2 ½	3	4
3000 lb	D	15.7	19.0	22.3	28.5	35.0	44.5	57.1	63.5	76.2	91.9	107.9	139.7
	W	31.7	35.0	38.1	47.7	50.8	60.4	66.5	79.2	85.8	91.9	107.9	120.6
	P	19.0	25.4	25.4	31.7	35.8	41.1	44.5	44.5	47.7	60.4	65.0	68.3
	G	4.8	4.8	4.8	6.3	6.3	9.6	9.6	11.2	12.7	15.7	19.0	22.3
6000 lb	D	22.3	25.4	31.7	38.1	44.5	57.1	63.5	76.2	91.9	107.9	127.0	158.7
	W	31.7	35.0	38.1	47.7	50.8	60.4	66.5	79.2	85.8	91.9	107.9	120.6
	P	-	26.9	26.9	33.3	38.1	42.9	46.0	47.7	50.8	63.5	68.3	74.7
	G	-	6.3	6.3	7.9	7.9	11.2	11.2	12.7	15.7	19.0	22.3	28.4
THREAD filetto NPT	B	6.4	8.1	9.1	10.9	12.7	14.7	17.0	17.8	19.0	23.6	25.9	27.7
	L ₂	6.7	10.2	10.4	13.6	13.9	17.3	17.9	18.4	19.2	28.9	30.5	33.0

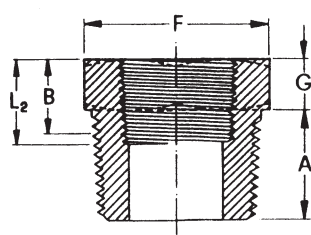

riduzioni esagonali M/F

To ANSI B 16.11 – BS 3799

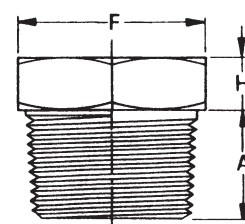

tappi testa esagonale

To ANSI B 16.11 – BS 3799

RATING serie	inch	NOMINAL PIPE SIZE					Ø NOMINALE						
		1/8	1/4	3/8	1/2	3/4	1	1 ¼	1 ½	2	2 ½	3	4
3/6000 lb	A	9.6	11.2	12.7	14.2	15.7	19.0	20.6	20.6	22.3	26.9	28.4	31.7
	F	11.0	16.0	17.5	22.0	27.0	35.0	44.5	51.0	63.5	76.0	89.0	117.5
	G	-	3.0	4.1	4.8	5.6	6.3	7.1	7.8	8.6	9.6	10.4	12.7
	H	6.3	6.3	7.9	7.9	9.6	9.6	14.2	15.7	17.5	19.0	20.6	31.7
	I	6.3	6.3	7.9	9.6	11.2	12.7	14.2	15.7	17.5	19.0	20.6	25.4
THREAD filetto NPT	B	6.4	8.1	9.1	10.9	12.7	14.7	17.0	17.8	19.0	23.6	25.9	27.7
	L ₂	6.7	10.2	10.4	13.6	13.9	17.3	17.9	18.4	19.2	28.9	30.5	33.0

Raccordi filettati - Threaded fittings

Raccorderia forgiata serie 2-3-6000 IN-A 105 AISI 304-316

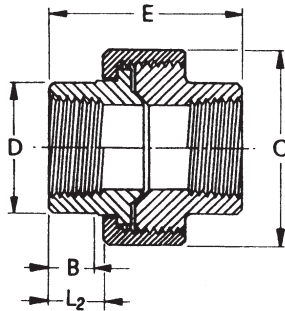

bocchettoni
To MSS SP 83 - BS 3799

RATING serie	inch	NOMINAL PIPE SIZE						Ø NOMINALE					
		1/8	1/4	3/8	1/2	3/4	1	1 1/4	1 1/2	2	2 1/2	3	4
3000 lb	C	35.0	35.0	40.0	46.0	55.5	64.5	78.0	87.0	104.0	124.0	150.0	187.0
	D	14.7	19.1	22.9	27.7	33.5	41.4	50.5	57.1	70.1	85.3	102.4	136.5
	E	41.4	41.4	46.0	49.0	56.9	52.0	71.1	76.5	86.1	118.0	109.0	153.0
6000 lb	C	46.0	46.0	64.5	64.5	87.0	87.0	104.0	124.0	-	-	-	-
	D	27.7	27.7	38.5	41.4	57.2	57.2	70.1	85.3	-	-	-	-
	E	49.0	49.0	62.0	62.0	76.5	76.5	86.1	118.0	-	-	-	-
THREAD filetto NPT	B	6.4	8.1	9.1	10.9	12.7	14.7	17.0	17.8	19.0	23.6	25.9	27.7
	L ₂	6.7	10.2	10.4	13.6	13.9	17.3	17.9	18.4	19.2	28.9	30.5	33.0

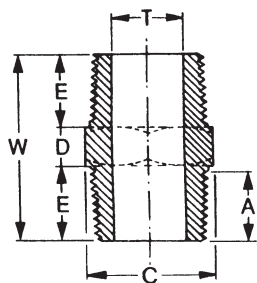

nippli esagonali
To BS 3799

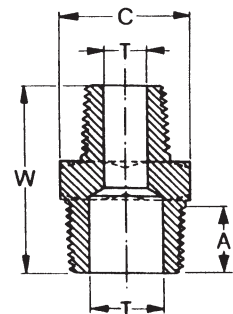

nippli esagonali ridotti
To BS 3799

RATING serie	inch	NOMINAL PIPE SIZE						Ø NOMINALE					
		1/8	1/4	3/8	1/2	3/4	1	1 1/4	1 1/2	2	2 1/2	3	4
3000 lb	w	26.0	36.0	40.0	48.0	52.0	60.0	66.0	68.0	71.0	94.0	102.0	110.0
	E	10.0	15.0	16.0	20.0	21.0	25.0	26.0	26.0	27.0	37.0	40.0	43.0
	D	6.0	6.0	8.0	8.0	10.0	10.0	14.0	16.0	17.0	20.0	22.0	24.0
	C	11.0	15.0	18.0	22.0	27.0	35.0	45.0	50.0	62.0	76.0	93.0	119.0
	T	-	8.0	11.0	14.0	19.0	24.0	32.0	38.0	49.0	58.2	73.0	96.0
6000 lb	W	26.0	36.0	40.0	48.0	52.0	60.0	66.0	68.0	71.0	94.0	102.0	110.0
	E	10.0	15.0	16.0	20.0	21.0	25.0	26.0	26.0	27.0	37.0	40.0	43.0
	D	6.0	6.0	8.0	8.0	10.0	10.0	14.0	16.0	17.0	20.0	22.0	24.0
	C	11.0	15.0	18.0	22.0	27.0	35.0	45.0	50.0	62.0	76.0	93.0	119.0
	M	-	25.4	31.7	38.1	44.5	57.1	63.5	76.2	91.9	-	-	-
	T	-	6.0	8.0	11.0	13.0	17.0	24.5	30.0	39.0	-	-	-
THREAD filetto NPT	A	9.6	11.2	12.7	14.2	15.7	19.0	20.6	20.6	22.3	26.9	28.4	31.7

Raccordi filettati e a tasca da saldare

Threaded and socket welding fittings

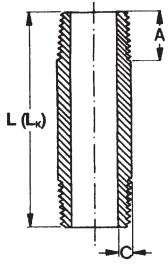

nippli tubo
To ANSI B 36.10

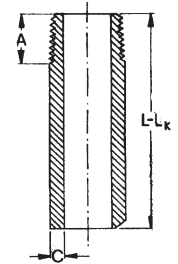

mezzi nippli
To ANSI B 36.10

TYPE/ SCHEDULE tipo/ schedula	inch	NOMINAL PIPE SIZE					Ø NOMINALE						
		1/8	1/4	3/8	1/2	3/4	1	1 1/4	1 1/2	2	2 1/2	3	4
STD SCH. 40	Ø	10.3	13.7	17.1	21.3	26.7	33.4	42.2	48.3	60.3	73.0	88.9	114.3
	C	1.7	2.2	2.3	2.8	2.9	3.4	3.6	3.7	3.9	5.2	5.5	6.0
	L _k	20.2	23.5	26.7	29.8	33.0	39.9	43.3	43.3	46.8	57.1	60.3	68.5
XS SCH. 80	C	2.4	3.0	3.2	3.7	3.9	4.6	4.8	5.1	5.5	7.0	7.6	8.6
	L _k	20.2	23.5	26.7	29.8	33.0	39.9	43.3	43.3	46.8	57.1	60.3	68.5
SCH. 160	C	-	-	-	4.8	5.6	6.4	6.4	7.1	8.7	9.5	11.1	13.5
	L _k	-	-	-	29.8	33.0	39.9	43.3	43.3	46.8	57.1	60.3	68.5
XXS	C	-	-	-	7.5	7.8	9.1	9.7	10.2	11.1	14.0	15.2	17.1
	L _k	-	-	-	29.8	33.0	39.9	43.3	43.3	46.8	57.1	60.3	68.5
THREAD filetto NPT	A	9.6	11.2	12.7	14.2	15.7	19.0	20.6	20.6	22.3	26.9	28.4	31.7

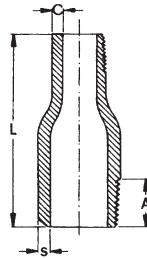

nippli tubo ridotti

To MSS SP 95 – ANSI B 36.10

TYPE/ SCHEDULE tipo/ schedula	inch	NOMINAL PIPE SIZE					Ø NOMINALE						
		1/8	1/4	3/8	1/2	3/4	1	1 1/4	1 1/2	2	2 1/2	3	4
STD SCH. 40	Ø	10.3	13.7	17.1	21.3	26.7	33.4	42.2	48.3	60.3	73.0	88.9	114.3
	C	1.7	2.2	2.3	2.8	2.9	3.4	3.6	3.7	3.9	5.2	5.5	6.0
	L	-	69.9	69.9	69.9	76.2	88.9	101.6	114.3	165.1	178.0	203.0	228.0
XS SCH. 80	C	2.4	3.0	3.2	3.7	3.9	4.6	4.8	5.1	5.5	7.0	7.6	8.6
	L	-	69.9	69.9	69.9	76.2	88.9	101.6	114.3	165.1	178.0	203.0	228.0
SCH. 160	C	-	-	-	4.8	5.6	6.4	6.4	7.1	8.7	9.5	11.1	13.5
	L	-	-	-	69.9	76.2	88.9	101.6	114.3	165.1	178.0	203.0	228.0
XXS	C	-	-	-	7.5	7.8	9.1	9.7	10.2	11.1	14.0	15.2	17.1
	L	-	-	-	69.9	76.2	88.9	101.6	114.3	165.1	178.0	203.0	228.0
THREAD filetto NPT	A	9.6	11.2	12.7	14.2	15.7	19.0	20.6	20.6	22.3	26.9	28.4	31.7

Raccordi filettati e a tasca da saldare

Threaded and socket welding fittings

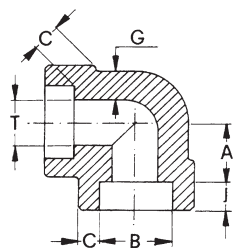

To ANSI B 16.11 – B 3799

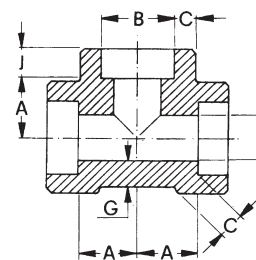

gomiti 90°

tee

RATING SERIE	INCH	NOMINAL PIPE SIZE						Ø NOMINALE						
		1/8	1/4	3/8	1/2	3/4	1	1 ¼	1 ½	2	2 ½	3	4	
3000 LB	A	max	11.9	11.9	15.0	17.2	20.5	24.4	28.9	33.8	40.1	43.7	59.7	69.1
		min	10.4	10.4	12.0	14.2	17.5	20.3	24.9	29.7	36.1	38.6	54.6	64.0
	C	max	3.2	3.8	4.0	4.7	4.9	5.7	6.1	6.4	6.9	8.8	9.5	10.7
		min	3.2	3.3	3.5	4.1	4.3	5.0	5.3	5.5	6.0	7.7	8.3	9.3
G	min	2.4	3.0	3.2	3.7	3.9	4.5	4.9	5.1	5.5	7.0	7.6	8.6	
	T	max	7.6	10.0	13.3	16.6	21.7	27.4	35.8	41.6	53.3	64.2	79.5	103.8
min		6.1	8.5	11.8	15.0	20.2	25.9	34.3	40.1	51.7	61.2	76.4	100.7	
6000 LB	A	max	11.9	15.0	17.2	20.5	24.4	28.9	33.8	40.1	43.6	59.6	67.0	82.2
		min	10.4	12.0	14.2	17.5	20.3	24.9	29.7	36.1	38.6	54.6	61.0	76.2
	C	max	4.0	4.6	5.0	6.0	7.0	7.9	7.9	8.9	10.9	11.9	13.9	16.9
		min	3.4	4.0	4.4	5.2	6.0	6.9	6.9	7.8	9.5	10.4	12.2	14.8
G	min	3.1	3.7	4.0	4.8	5.6	6.3	6.3	7.1	8.7	9.6	11.2	13.6	
	T	max	4.8	7.1	9.9	12.5	16.3	21.5	30.2	34.7	43.6	54.8	66.3	88.0
min		3.2	5.6	8.4	11.0	14.8	19.9	28.7	33.2	42.1	53.3	64.8	86.5	
SOCKET tasca	B	max	10.9	14.3	17.8	22.0	27.3	34.1	42.8	48.9	61.4	74.2	90.2	115.8
		min	10.7	14.1	17.5	21.7	27.0	33.8	42.5	48.6	61.1	73.8	89.8	115.4
J	min	9.7	9.7	9.7	9.7	12.7	12.7	12.7	12.7	15.7	15.7	15.7	19.0	

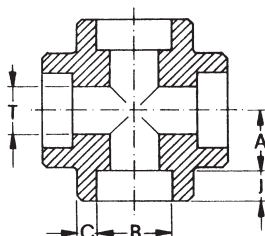

To ANSI B 16.11 – B 3799

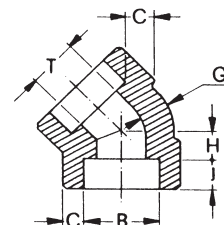

croci

gomiti 45°

RATING SERIE	INCH	NOMINAL PIPE SIZE						Ø NOMINALE						
		1/8	1/4	3/8	1/2	3/4	1	1 ¼	1 ½	2	2 ½	3	4	
3000 LB	A	max	11.9	11.9	15.0	17.2	20.5	24.4	28.9	33.8	40.1	43.7	59.7	69.1
		min	10.4	10.4	12.0	14.2	17.5	20.3	24.9	29.7	36.1	38.6	54.6	64.0
	C	max	3.2	3.8	4.0	4.7	4.9	5.7	6.1	6.4	6.9	8.8	9.5	10.7
		min	3.2	3.3	3.5	4.1	4.3	5.0	5.3	5.5	6.0	7.7	8.3	9.3
G	min	2.4	3.0	3.2	3.7	3.9	4.5	4.9	5.1	5.5	7.0	7.6	8.6	
	T	max	7.6	10.0	13.3	16.6	21.7	27.4	35.8	41.6	53.3	64.2	79.5	103.8
min		6.1	8.5	11.8	15.0	20.2	25.9	34.3	40.1	51.7	61.2	76.4	100.7	
6000 LB	A	max	11.9	15.0	17.2	20.5	24.4	28.9	33.8	40.1	43.6	59.6	67.0	82.2
		min	10.4	12.0	14.2	17.5	20.3	24.9	29.7	36.1	38.6	54.6	61.0	76.2
	C	max	4.0	4.6	5.0	6.0	7.0	7.9	7.9	8.9	10.9	11.9	13.9	16.9
		min	3.4	4.0	4.4	5.2	6.0	6.9	6.9	7.8	9.5	10.4	12.2	14.8
G	min	3.1	3.7	4.0	4.8	5.6	6.3	6.3	7.1	8.7	9.6	11.2	13.6	
	T	max	4.8	7.1	9.9	12.5	16.3	21.5	30.2	34.7	43.6	54.8	66.3	88.0
min		3.2	5.6	8.4	11.0	14.8	19.9	28.7	33.2	42.1	53.3	64.8	86.5	
SOCKET tasca	B	max	10.9	14.3	17.8	22.0	27.3	34.1	42.8	48.9	61.4	74.2	90.2	115.8
		min	10.7	14.1	17.5	21.7	27.0	33.8	42.5	48.6	61.1	73.8	89.8	115.4
J	min	9.7	9.7	9.7	9.7	12.7	12.7	12.7	12.7	15.7	15.7	15.7	19.0	

Raccordi filettati e a tasca da saldare

Threaded and socket welding fittings

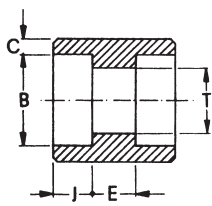

manicotti

To ANSI B 16.11 – BS 3799

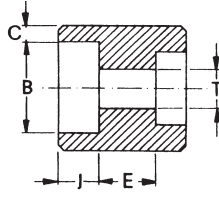

manicotti ridotti

To ANSI B 16.11 – BS 3799

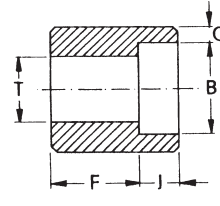

mezzi manicotti

To ANSI B 16.11 – BS 3799

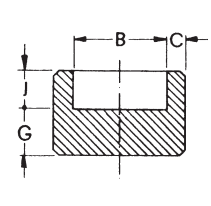

tappi femmina

BS 3799

RATING SERIE	INCH	NOMINAL PIPE SIZE					Ø NOMINALE							
		1/8	1/4	3/8	1/2	3/4	1	1 ¼	1 ½	2	2 ½	3	4	
3000 LB	C	ave	3.2	3.8	4.0	4.7	4.9	5.7	6.1	6.4	6.9	8.8	9.5	10.7
		min	3.2	3.3	3.5	4.1	4.3	5.0	5.3	5.5	6.0	7.7	8.3	9.3
	E	max	7.9	7.9	9.4	12.7	12.7	16.8	16.8	16.8	23.1	24.1	24.1	24.1
		min	4.8	4.8	3.3	6.6	6.6	8.6	8.6	8.6	15.0	14.0	14.0	14.0
	F	max	16.5	16.5	19.0	23.9	25.4	30.5	32.3	33.8	43.2	45.5	47.0	50.3
		min	15.0	15.0	16.0	20.8	22.4	26.4	28.2	29.7	39.1	40.4	41.9	45.2
G	min	4.0	7.0	7.0	8.0	10.0	11.0	13.0	14.0	18.0	21.0	24.0	30.0	
	T	max	7.6	10.0	13.3	16.6	21.7	27.4	35.8	41.6	53.3	64.2	79.5	103.8
		min	6.1	8.5	11.8	15.0	20.2	25.9	34.3	40.1	51.7	61.2	76.4	100.7
6000 LB	C	ave	4.0	4.6	5.0	6.0	7.0	7.9	7.9	8.9	10.9	11.9	13.9	16.9
		min	3.4	4.0	4.4	5.2	6.0	6.9	6.9	7.8	9.5	10.4	12.2	14.8
	E	max	7.9	7.9	9.4	12.7	12.7	16.8	16.8	16.8	23.1	24.1	24.1	24.1
		min	4.8	4.8	3.3	6.6	6.6	8.6	8.6	8.6	15.0	14.0	14.0	14.0
	F	max	16.5	16.5	19.0	23.9	25.4	30.5	32.3	33.8	43.2	45.5	47.0	50.3
		min	15.0	15.0	16.0	20.8	22.4	26.4	28.2	29.7	39.1	40.4	41.9	45.2
G	min	6.0	8.0	10.0	11.0	13.0	14.0	18.0	19.0	24.0	29.0	34.0	44.0	
	T	max	4.8	7.1	9.9	12.5	16.3	21.5	30.2	34.7	43.6	54.8	66.3	88.0
		min	3.2	5.6	8.4	11.0	14.8	19.9	28.7	33.2	42.1	53.3	64.8	86.5
SOCKET tasca	B	max	10.9	14.3	17.8	22.0	27.3	34.1	42.8	48.9	61.4	74.2	90.2	115.8
		min	10.7	14.1	17.5	21.7	27.0	33.8	42.5	48.6	61.1	73.8	89.8	115.4
	J	min	9.7	9.7	9.7	9.7	12.7	12.7	12.7	12.7	15.7	15.7	15.7	19.0

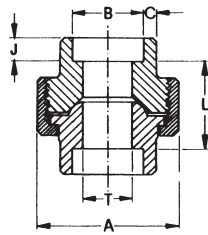

bocchettoni F/F

To ANSI B 16.11 – BS 3799 To MSS SP 83 – BS 3799

RATING SERIE	INCH	NOMINAL PIPE SIZE					Ø NOMINALE							
		1/8	1/4	3/8	1/2	3/4	1	1 ¼	1 ½	2	2 ½	3	4	
3000 LB	A	nom	35.0	35.0	40.0	46.0	55.5	64.5	78.0	87.0	104.0	124.0	150.0	187.0
		C	ave	3.2	3.8	4.0	4.7	4.9	5.7	6.1	6.4	6.9	8.8	9.5
		min	3.2	3.3	3.5	4.1	4.3	5.0	5.3	5.5	6.0	7.7	8.3	9.3
	L	max	22.4	22.4	26.9	26.9	31.8	34.3	40.6	42.2	45.5	61.7	63.8	97.0
		min	19.0	19.0	20.6	20.6	25.4	26.2	32.5	34.0	37.3	52.1	53.6	85.0
	T	max	6.8	9.8	13.9	17.5	21.8	28.1	35.8	41.6	52.5	64.7	77.7	102.8
min		6.4	9.4	13.5	17.1	21.4	27.7	35.4	41.2	52.1	64.3	77.3	100.7	
6000 LB	A	nom	-	46.0	46.0	64.5	64.5	87.0	87.0	104.0	124.0	-	-	-
		C	ave	-	4.6	5.0	6.0	7.0	7.9	7.9	8.9	10.9	-	-
		min	-	4.0	4.4	5.2	6.0	6.9	6.9	7.8	9.5	-	-	-
	L	max	-	31.0	31.0	38.0	35.5	46.0	43.5	52.5	81.0	-	-	-
		min	-	28.5	28.5	36.0	33.0	43.0	40.0	48.0	75.0	-	-	-
	T	max	-	7.1	9.9	12.5	16.3	21.5	30.2	34.7	43.6	-	-	-
min		-	5.6	8.4	11.0	14.8	19.9	28.7	33.2	42.1	-	-	-	
SOCKET tasca	B	max	10.9	14.3	17.8	22.0	27.3	34.1	42.8	48.9	61.4	74.2	90.2	115.8
		min	10.7	14.1	17.5	21.7	27.0	33.8	42.5	48.6	61.1	73.8	89.8	115.4
	J	min	9.7	9.7	9.7	9.7	12.7	12.7	12.7	12.7	15.7	15.7	15.7	19.0

Raccordi filettati e a tasca da saldare

Threaded and socket welding fittings

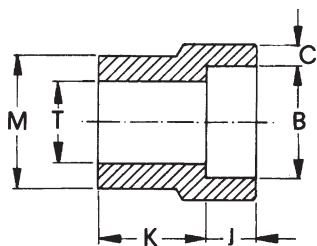

inserti di riduzione tipo 1

STANDARD DIMENSIONS

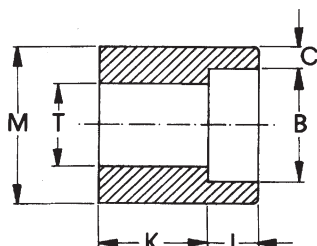

inserti di riduzione tipo 2

STANDARD DIMENSIONS

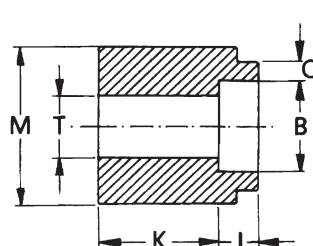

inserti di riduzione tipo 3

STANDARD DIMENSIONS

		RATING/serie 3000 lb																					
		NOMINAL PIPE SIZE \varnothing nominale																					
inch		1/2			3/4			1			1 1/4			1 1/2			2			2 1/2			
		type			type			type			type			type			type						
		1	2	3	1	2	3	1	2	3	1	2	3	1	2	3	1	2	3	1	2	3	
K	1/4		15.7				15.7			23.9													
	3/8	23.9					15.7			23.9			24.6										
	1/2				26.9					23.9			24.6				26.2			29.5			32.5
	3/4							28.4					22.1			22.1			25.4			29.5	
	1											31.7				33.3			25.4			29.5	
	1 1/4														33.3				25.4			29.5	
	1 1/2																	38.1					27.5
2																				41.4			
M			21.6			26.9			33.6			42.4			48.5			60.9			73.6		
C	ave		4.7			4.9			5.7			6.1			6.4			6.9					
	min		4.1			4.3			5.0			5.3			5.5			6.0					
T	max		16.6			21.7			27.4			35.8			41.6			53.3					
	min		15.0			20.2			25.9			34.3			40.1			51.7					

		RATING/serie 6000 lb																				
		NOMINAL PIPE SIZE \varnothing nominale																				
inch		1/2			3/4			1			1 1/4			1 1/2			2			2 1/2		
		type			type			type			type			type			type					
		1	2	3	1	2	3	1	2	3	1	2	3	1	2	3	1	2	3	1	2	3
K	1/4	30.2					25.4			28.4												
	3/8	30.2					25.4			28.4			32.5									
	1/2				33.3					40.1			32.0			39.0			38.9			46.5
	3/4							42.					29.0			35.1			36.1			43.9
	1											43.2			49.0			36.1			36.1	43.9
	1 1/4														51.0							42.2
	1 1/2																	46.0				47.5
2																				54.1		
M			21.6			26.9			33.6			42.4			48.5			60.9			73.6	
C	ave		6.0			7.0			7.9			7.9			8.9			10.6				
	min		5.2			6.0			6.9			6.9			7.8			9.5				
T	max		12.5			16.3			21.5			30.2			34.7			43.6				
	min		11.0										30.2			34.7			43.6			

		SOCKET/tasca																				
B	min		22.0			27.3			34.1			42.8			48.9			61.4				
	max		21.7			27.0			33.8			42.5			48.6			61.1				
J	min		9.7			12.7			12.7			12.7			12.7			15.7				

		3000 lb		6000 lb	
		1/4	3/8	1/4	3/8
C	ave	3.8	4.0	4.6	5.0
	min	3.3	3.5	4.0	4.4
T	max	10.0	13.3	7.1	9.9
	min	8.5	11.8	5.6	8.4
B	max	14.3	17.8	14.3	17.8
	min	14.1	17.5	14.1	17.5
J	min	9.7	9.7	9.7	9.7

Raccordi filettati e a tasca da saldare

Threaded and socket welding fittings

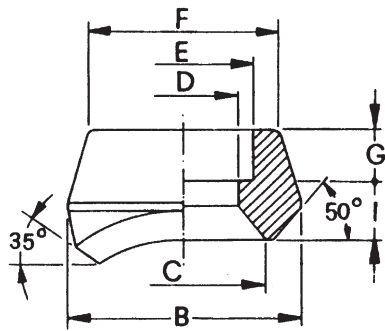

derivazioni a tasca

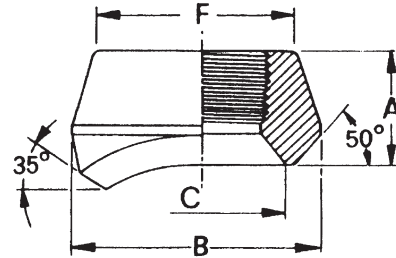

derivazioni filettate

STANDARD DIMENSIONS

RATING serie	inch	NOMINAL PIPE SIZE					Ø NOMINALE						
		1/8	1/4	3/8	1/2	3/4	1	1 ¼	1 ½	2	2 ½	3	4
3000 lb	A	17.5	17.5	20.6	25.4	27.0	33.3	33.3	34.9	38.1	46.0	50.8	57.1
	B	25.4	25.4	31.8	34.9	44.5	54.0	65.1	73.0	88.9	103.2	122.2	152.4
	C	15.9	15.9	19.0	23.8	30.2	36.5	44.5	50.8	65.1	76.2	93.7	120.6
	D	6.8	9.2	12.5	15.8	20.9	26.6	35.0	40.9	52.5	62.7	77.9	102.3
	E	10.7	14.1	17.5	21.7	27.0	33.8	42.6	48.6	61.1	73.8	89.8	115.4
	F	22.2	22.2	25.4	31.7	36.5	46.0	55.6	61.9	74.6	87.3	104.8	130.2
	G	9.5	9.5	9.5	11.1	12.7	13.5	15.1	15.1	17.5	23.8	28.6	29.4
	I	8.0	8.0	11.1	14.3	14.3	19.8	18.2	19.8	20.6	22.2	22.2	27.7
6000 lb	A	-	-	-	31.7	36.5	39.7	41.3	42.8	58.7	-	-	-
	B	-	-	-	44.5	50.8	61.9	69.9	82.6	103.2	-	-	-
	C	-	-	-	19.0	25.4	33.3	38.1	49.2	58.7	-	-	-
	D	-	-	-	14.3	19.0	25.4	33.3	38.1	42.9	-	-	-
	E	-	-	-	21.7	27.0	33.8	42.6	48.6	61.1	-	-	-
	F	-	-	-	36.7	45.2	57.1	65.1	76.2	92.1	-	-	-
	G	-	-	-	9.5	14.3	15.9	20.6	20.6	22.2	-	-	-
	I	-	-	-	22.2	22.2	23.8	20.6	22.2	36.5	-	-	-

Derivazioni rinforzate a saldare in testa

Reinforced butt-welding outlets

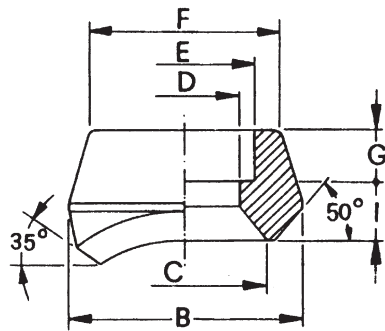

derivazioni a tasca

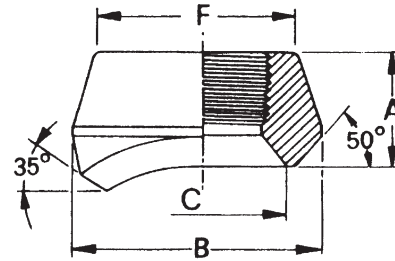

derivazioni filettate

STANDARD DIMENSIONS

TYPE/ SCHEDULE tipo/ schedula	inch	NOMINAL PIPE SIZE					Ø NOMINALE						
		1/8	1/4	3/8	1/2	3/4	1	1 ¼	1 ½	2	2 ½	3	4
STANDARD WEIGHT AND EXTRA STRONG	A	14.3	14.3	19.0	19.0	22.2	27.0	31.7	33.3	38.1	41.3	44.4	50.8
	B	25.4	25.4	31.7	34.9	44.5	54.0	65.1	73.0	88.9	103.2	122.2	152.4
	C	15.9	15.9	19.0	23.8	30.2	36.5	44.5	50.8	65.1	76.2	93.7	120.6
SCHEDULE 160 AND DOUBLE EXTRA STRONG	A	-	-	-	28.6	31.7	38.1	44.5	50.8	55.6	61.9	73.0	84.1
	B	-	-	-	34.9	44.5	50.8	61.9	69.9	81.0	96.8	120.6	152.4
	C	-	-	-	14.3	19.0	25.4	33.3	38.1	42.9	54.0	73.0	98.4

Raccordi filettati - Threaded fittings

Tabella pesi (espressi in Kg) - Weights table (unit in grammes)



TYPE /RATING tipo/serie	inch	1/8	1/4	3/8	1/2	3/4	1	1 ¼	1 ½	2	2 ½	3	4
90° ELBOW gomiti 90°	2000	-	0,095	0,130	0,245	0,295	0,500	0,790	0,935	1,725	2,430	4,445	11,000
	3000	0,095	0,160	0,280	0,385	0,685	1,020	1,200	2,495	2,785	5,145	7,800	14,100
	6000	0,180	0,315	0,420	0,720	1,280	1,605	2,770	3,780	6,100	9,440	17,000	14,100
45° ELBOW gomiti 45°	2000	-	0,090	0,110	0,205	0,250	0,400	0,650	0,750	1,280	2,750	3,360	9,200
	3000	0,095	0,125	0,250	0,320	0,515	0,935	0,980	1,880	2,310	3,695	5,950	10,000
	6000	0,145	0,270	0,350	0,575	1,035	1,280	2,150	2,970	4,200	7,750	14,100	10,000
TEE ti	2000	-	0,120	0,170	0,305	0,400	0,645	0,980	1,430	1,970	3,000	5,700	12,400
	3000	0,155	0,215	0,370	0,545	0,835	1,370	1,720	3,120	3,410	5,935	9,500	17,500
	6000	0,250	0,430	0,620	0,975	1,590	2,200	3,350	4,675	8,000	13,000	19,200	17,500
REDUCING TEE tee ridotti	3000	-	0,210	0,370	0,560	0,935	1,550	1,890	3,380	4,100	7,400	12,000	21,300
	6000	-	0,300	0,550	0,800	1,400	2,300	2,800	4,950	6,900	11,500	17,800	32,000
CROSS croci	2000	-	0,180	0,160	0,330	0,430	0,740	1,150	1,450	2,350	4,650	7,220	15,800
	3000	0,240	0,270	0,410	0,595	0,975	1,635	2,000	3,650	4,950	9,500	12,350	22,200
	6000	0,280	0,480	0,710	1,155	1,800	2,500	4,050	5,150	11,200	14,000	24,750	22,200
STREET ELBOW gomiti M/F	3000	-	0,140	0,220	0,325	0,550	0,910	1,230	1,930	2,200	-	-	-
COUPLING manicotti	2/3000	0,040	0,050	0,070	0,140	0,190	0,430	0,690	0,985	1,1405	2,385	2,905	5,510
	6000	0,075	0,105	0,180	0,300	0,460	0,885	1,400	1,915	2,860	3,900	5,200	9,250
REDUCING COUPLING manicotti ridotti	2/3000	-	0,070	0,080	0,170	0,220	0,475	0,880	1,380	2,045	2,970	4,580	8,250
	6000	-	0,120	0,185	0,345	0,480	1,000	1,620	2,140	3,200	4,400	5,700	10,100
HALF COUPLING mezzi manicotti	2/3000	0,015	0,025	0,035	0,070	0,100	0,220	0,385	0,570	0,700	1,240	1,525	3,870
	6000	0,025	0,050	0,090	0,165	0,230	0,480	0,680	0,980	1,425	2,000	2,700	4,800
CAP tappi femmina	2/3000	0,025	0,045	0,060	0,115	0,175	0,380	0,610	0,845	1,165	1,905	2,775	4,960
	6000	0,045	0,095	0,145	0,240	0,385	0,755	0,920	1,365	2,140	2,900	4,100	7,500
UNION bocchettoni	2/3000	0,175	0,160	0,240	0,335	0,520	0,760	1,125	1,565	2,365	5,010	7,500	15,500
	6000	-	0,370	0,400	0,870	1,575	2,100	1,900	3,085	6,500	-	-	-
HEX H. PLUG testa tappi esag.	3/6000	0,015	0,030	0,045	0,075	0,130	0,230	0,450	0,585	0,980	1,800	2,540	5,095
HEX NIPPLE nippli esagonali	3000	0,015	0,030	0,045	0,075	0,105	0,205	0,325	0,400	0,640	1,020	1,650	2,755
	6000	0,020	0,040	0,055	0,090	0,165	0,300	0,460	0,655	1,020	1,700	2,100	4,645
REDUCING HEX NIPPLE nippli esagonali ridotti	3000	-	0,030	0,050	0,060	0,110	0,225	0,320	0,415	0,635	1,270	2,060	3,440
	6000	-	0,035	0,055	0,095	0,140	0,305	0,420	0,635	0,910	1,680	2,750	4,500
HEX H. BUSHING riduzioni esag. ridotti	3/6000	-	0,015	0,020	0,040	0,050	0,115	0,310	0,375	0,780	0,940	1,730	4,300
PIPE NIPPLE L=100 nippli tubo L=100	STD	0,030	0,060	0,080	0,120	0,140	0,230	0,330	0,465	0,520	0,840	1,210	1,350
	XS	0,040	0,075	0,105	0,150	0,200	0,260	0,365	0,490	0,665	1,010	1,225	2,000
	160	-	-	-	0,180	0,270	0,350	0,540	0,660	1,070	1,400	2,050	3,335
	XXS	-	-	-	0,240	0,345	0,500	0,770	0,885	1,285	1,900	2,600	4,000
MM	6	8	10	15	20	25	32	40	50	65	80	100	

Raccordi a tasca da saldare - Sockets-weldings fittings

Tabella pesi (espressi in Kg) - Weights table (unit in grammes)



TYPE /RATING tipo/serie	inch	1/8	1/4	3/8	1/2	3/4	1	1 ¼	1 ½	2	2 ½	3	4
90° ELBOW gomiti 90°	3000	0,100	0,095	0,130	0,245	0,320	0,470	0,765	0,980	1,640	2,935	4,525	11,500
	6000	0,100	0,160	0,290	0,415	0,680	1,150	1,380	2,680	3,215	5,850	8,400	15,500
45° ELBOW gomiti 45°	3000	0,090	0,085	0,100	0,195	0,255	0,395	0,650	0,800	1,190	2,100	3,400	9,150
	6000	0,095	0,120	0,230	0,335	0,540	1,000	1,120	2,070	2,705	3,750	6,300	10,500
TEE ti	3000	0,135	0,115	0,180	0,315	0,415	0,620	0,975	1,350	1,965	2,785	5,550	12,400
	6000	0,140	0,235	0,390	0,590	0,880	1,520	1,750	3,480	3,900	7,250	11,000	18,700
REDUCING TEE tl ridotti	3000	-	0,150	0,200	0,355	0,460	0,740	1,115	1,600	2,570	3,400	6,750	15,100
	6000	-	0,235	0,400	0,600	0,880	1,590	1,820	3,820	4,220	8,100	12,350	20,900
CROSS croci	3000	0,150	0,140	0,180	0,340	0,450	0,750	1,200	1,720	2,450	3,600	7,400	16,500
	6000	0,186	0,310	0,490	0,760	1,100	2,000	2,225	4,480	5,200	9,500	14,600	24,500
COUPLING manicotti	2/3000	0,040	0,055	0,070	0,125	0,185	0,275	0,385	0,460	0,925	1,325	1,550	3,000
	6000	0,150	0,075	0,100	0,170	0,245	0,420	0,490	0,710	1,405	1,900	2,250	4,200
REDUCING COUPLING manicotti ridotti	2/3000	-	0,060	0,085	0,170	0,210	0,395	0,490	0,635	1,235	1,600	2,150	3,900
	6000	-	0,090	0,120	0,200	0,280	0,485	0,650	0,900	1,645	2,500	3,000	5,800
HALF COUPLING mezzi manicotti	2/3000	0,050	0,060	0,085	0,145	0,205	0,325	0,460	0,575	1,040	1,605	2,125	3,850
	6000	0,060	0,085	0,150	0,210	0,300	0,485	0,620	0,815	1,635	2,200	2,650	5,000
CAP tappi femmina	2/3000	0,030	0,035	0,075	0,105	0,165	0,245	0,380	0,720	0,955	1,350	2,115	3,300
	6000	0,040	0,075	0,110	0,150	0,250	0,400	0,565	0,920	1,320	2,000	3,250	4,800
UNION bocchettoni	2/3000	0,190	0,180	0,230	0,345	0,520	0,750	1,225	1,620	2,420	4,650	7,500	13,900
	6000	-	0,385	0,420	0,900	1,650	2,160	2,050	3,200	6,750	-	-	-
CONCENTRIC AND ECCENTRIC SWAGE NIPPLE nippli tubo ridotti concentrici ed eccentrici	STD	-	0,042	0,063	0,090	0,120	0,215	0,330	0,450	0,910	1,320	2,300	3,100
	XS	-	0,050	0,075	0,105	0,170	0,280	0,410	0,610	1,075	1,710	2,825	4,250
	160	-	-	-	0,115	0,180	0,315	0,530	0,755	1,655	2,250	4,000	5,850
	XXS	-	-	-	0,140	0,245	0,400	0,790	0,975	1,970	3,000	5,350	7,700
REDUCER INSERT inserti ridotti	3000	-	0,040	0,055	0,060	0,90	0,170	0,240	0,360	0,725	-	-	-
	6000	-	0,060	0,080	0,090	0,140	0,260	0,370	0,540	1,050	-	-	-
90° BRANCHES SW & THR. END derivazioni 90°	3000	-	0,075	0,115	0,130	0,195	0,370	0,500	0,750	1,075	1,640	2,720	4,020
	6000	-	0,160	0,180	0,285	0,405	0,670	0,950	1,130	3,100	-	-	-
90° BRANCHES BW END derivazioni 90° a saldare di testa	STD	-	0,075	0,060	0,090	0,120	0,265	0,390	0,500	0,900	1,120	1,800	3,550
	XS	-	0,050	0,070	0,100	0,140	0,290	0,420	0,560	0,990	1,220	2,000	3,800
	160	-	-	-	0,130	0,160	0,330	0,600	0,800	1,200	1,650	2,870	4,700
	XXS	-	-	-	0,150	0,185	0,365	0,670	0,880	1,330	1,770	3,150	5,200
	MM	6	8	10	15	20	25	32	40	50	65	70	100